

DUDLEY ILLUSION BASIN™

FRAME FOR WALL-HUNG BASINS

Product Description

The Dudley Illusion Basin is a strong, in-wall support frame for wall-hung basins.

Uses

Unique, rotating wall and floor fixing brackets enable the frame to be installed into corners and against flat walls.

Special Features

The wall fixing brackets (inset 2) can be fixed at any angle through 180 degrees. This enables the frame to be installed into most ducted applications and helps to overcome uneven rear walls. These brackets are reversible and allow the frame to be fixed between 150mm and 200mm from the rear wall.

The floor fixing brackets (inset 3) unscrew from the frame leg and can be rotated through 360 degrees. Combined with the wall brackets, these simplify and speed up installation.

The legs (inset 4) can be quickly and easily adjusted to provide basin height fixing flexibility. This enables the frame to be used in most applications from traditional bathrooms and washrooms to modern wet rooms.

Technical Information

- Wall brackets can be fixed through 180 degrees
- Floor brackets rotate through 360 degrees
- Strong steel tubular section construction
- Waste pipe clamp
- Supplied with floor & basin fixing bolts
- Blue painted finish with galvanised wall & floor brackets
- Passes 400Kg load test based on EN 997

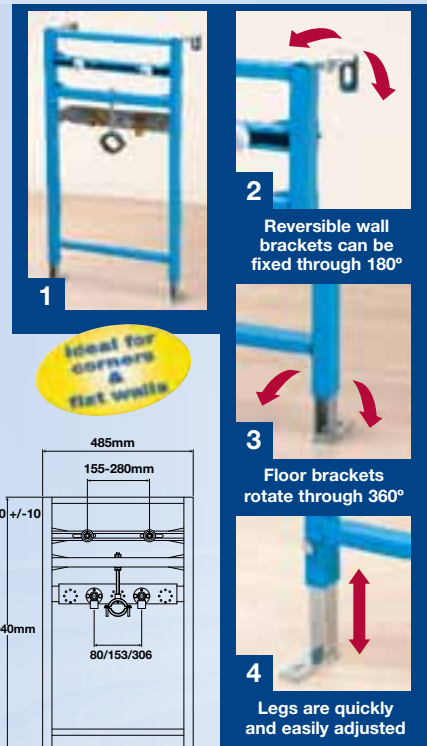
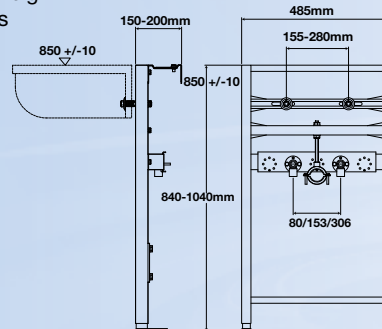

DUDLEY SENTINEL™

BRACKETS FOR WALL-HUNG WC PANS

Product Description

The Dudley Sentinel is a strong, easy to handle cast iron support bracket for wall-hung WC pans.

Uses

Sentinel brackets can be installed into corners, bathroom furniture and against flat walls. Two brackets are needed to support a pan and these can be supplied with a set of fittings. The brackets can be used with any lever, pushbutton or electronically operated Dudley concealed cistern.

Special Features

A vertical slot (insets 2 and 3) provides pan height fixing flexibility. A useful top hole enables a spacing rod upto M12 (not included) to be added on site if required.

Technical Information

- Strong cast iron construction
- Grey painted finish
- Can be supplied with floor & pan fixing bolts
- Passes 400Kg load test based on EN 997

