

SYMPTOM	POSSIBLE CAUSE	REMEDY
A No water flow from inlet	Mains supply tap not open	Open supply tap
	Isolating valve not open	Open isolating valve
	Filter blocked	Remove filter and clean
	Float arm not free to move	Mount valve correctly, straighten bent float stem
	Float stuck on float chamber	Adjust float and chamber height (ensure float remains inside float chamber at all times)
B Inlet valve not shutting off	Seal missing on float lever arm	Replace seal in arm
	Filter and 'O' ring missing	Replace filter and 'O' ring
	Float chamber fouling wall of cistern	Check mounting of valve
	Valve has become dislodged from mounting bracket	Re-engage valve in bracket
	Float chamber/float set too high	Adjust float chamber/float position
	Float lever arm dislodged from mounting	Refit lever arm or replace arm
	Front nut loose	Tighten nut
	Blue restrictor not fitted at very high mains pressure	Fit blue restrictor
	Monitoring pin seized	Replace diaphragm assembly
	Float adjustment stem bent	Straighten stem
C Low flow from inlet valve	Blue restrictor fitted in tank fed system	Remove blue restrictor
	Filter blocked	Clean filter
D Turbulent and noisy flow from inlet valve	Blue restrictor not fitted in mains fed system	Fit blue restrictor
E Internally overflowing	Inlet valve not shutting off	See symptom B above
	Water level set too high	Lower float on inlet valve
F Outlet valve not closing (If water continually running into pan)	Bellows not evacuating all air	Remove and reattach air tubes
	Build up of debris on seal face of housing or seal	Clean surfaces
G Outlet valve closing before full volume delivered	Seal not clearing window	Check for leaks on bellows and push button
	Lack of air to inflate bellows	Check for leaks in push button
	Push button leaking	Obtain new button
	Bellows poorly fitted to lever mount	Push fit bellows into lever mount
H Outlet valve not operating with push button	Air tubes not connected	Re-connect air tubes
	Bellows poorly fitted to lever mount	Trim back pipe to get tight fit
	Bellows leaking	Push fit bellows into lever mount / replace bellows
	Push button leaking	Obtain new button
	Kinked air tubes	Unkink or replace air tubes
I Leaking from flush pipe connection	Damaged 'O' rings on cistern outlet	Replace 'O' rings
	Flush pipe seam protruding	Trim seam with knife
	Flush pipe cut at angle	Replace flush pipe and cut square
	Flush pipe cracked	Replace flush pipe
J Partial flush volume when operating full flush button	Wrong position of pneumatic pipes	Substitute pipes
K Full flush volume when operating partial flush button	Adjustable weight not retained on locating studs	Re-connect weight
	Wrong position of air tubes	Substitute air tubes
L Button loose in wall/panel	Collet not located correctly	Ensure collet is fully engaged

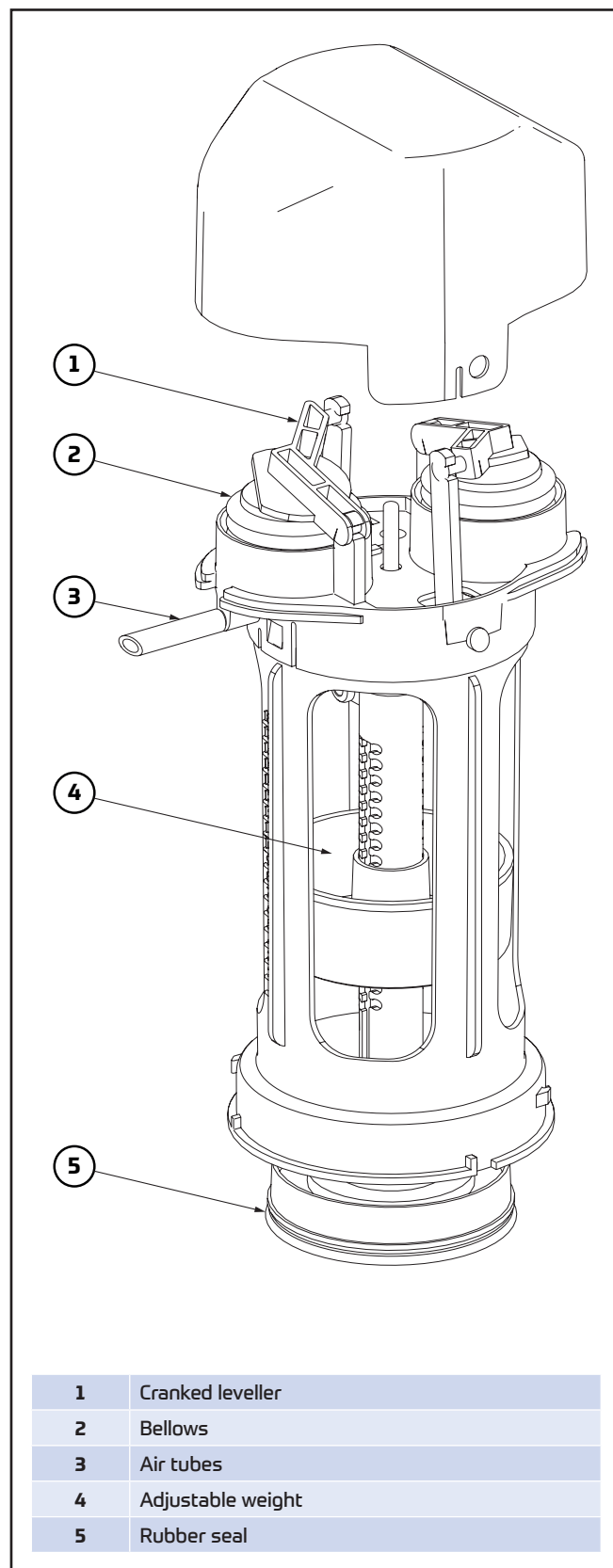
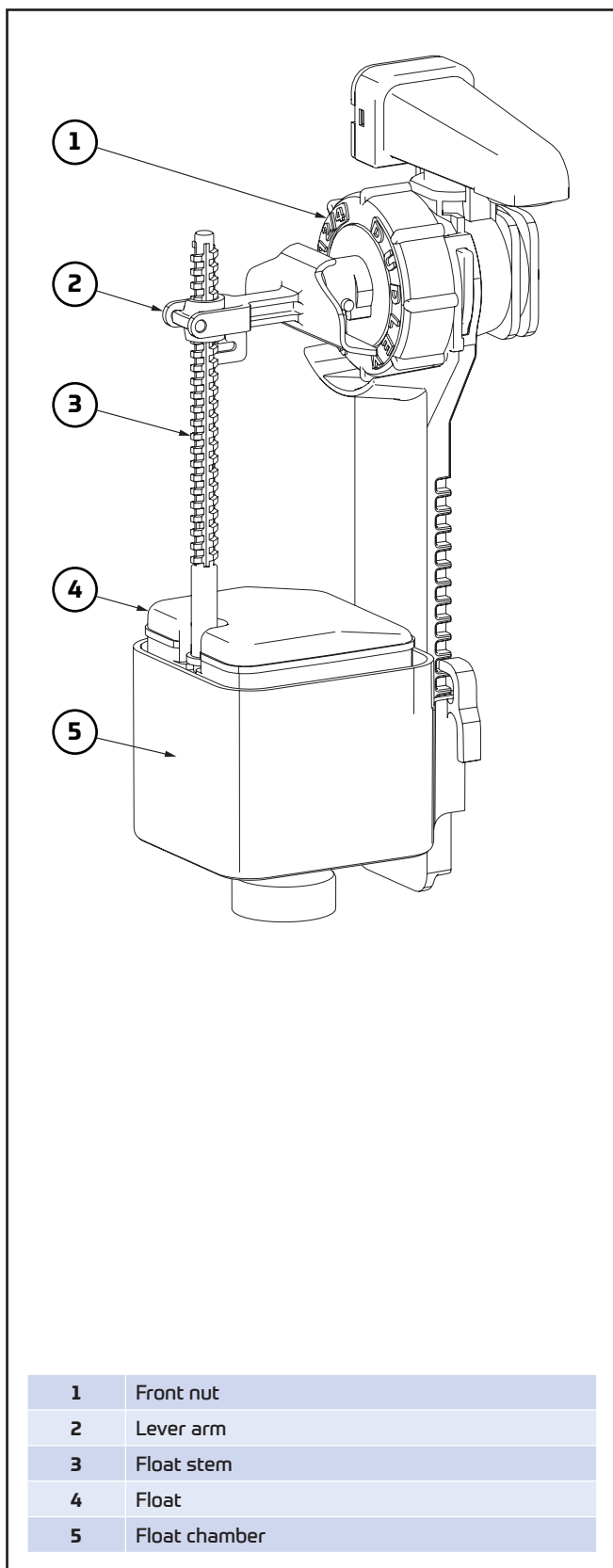

© 2025 TD_SISLF324180_11708 Iss E

Thomas Dudley
295 Birmingham New Road
Dudley, West Midlands
United Kingdom
DY1 4SJ

t +44 (0)121 557 5411
f +44 (0)121 557 5345
e info@thomasdudley.co.uk
w www.thomasdudley.co.uk/plumbing

T H O M A S
D U D L E Y

